

# ■ Pressacavo doppia tenuta 6018ADS

## Double seal cable gland 6018ADS

### Cavo armato

#### Armoured cable



Pressacavo doppia tenuta, cavo armato bloccaggio sotto armatura e messa a terra dell'armatura

Double seal cable gland, armoured cable under armour locking and armour grounding

#### Materiale

- Ottone
- Ottone nichelato
- Acciaio inox AISI 316L

#### Material

- Brass
- Nickel-plated brass
- AISI 316L stainless steel

#### Guarnizioni

- EPDM (-40/+80°C)
- Silicone (-65/+130°C)

Guarnizione O-Ring di serie

#### Seals

- EPDM (-40/+80°C)
- Silicone (-65/+130°C)

Standard O-Ring seal

#### Dotazioni

- Singolo gommino
- Kit Gommini (comprende il pressacavo e una dotazione di gommini per molteplici tipologie di serraggio)

#### Components

- Single rubber seal
- Rubber seal kit (includes cable gland and a supply of rubber seals for multiple types of fastening)

#### Filettature

- Metrico CEI EN 60423 (IEC 60423)

#### Threading

- CEI EN 60423 (IEC 60423) Metric

#### Zone



#### A richiesta

- GAS cilindrico UNI ISO 228
- PG DIN 40430
- GAS conico ISO 7/1
- NPT ANSI B1 20.1

#### On request

- UNI ISO 228 GAS cylindrical
- PG DIN 40430
- ISO 7/1 GAS tapered
- NPT ANSI B1 20.1

#### Modi di protezione

##### Protection modes

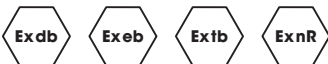

- II 2G Ex db IIC Gb
- II 2G Ex eb IIC Gb
- II 2D Ex tb IIIC Db IP66/68
- II 3G Ex nR IIC Gc

#### Nota

Per cavi serie SWA richiedere cono di serraggio in versione ridotta.

#### Note

For SWA series cables request clamping cone in reduced version.

- Standard IECEx  
**IEC 60079-0; IEC 60079-1; IEC 60079-7; IEC 60079-11; IEC 60079-15; IEC 60079-31**
- Standard ATEX  
**EN 60079-0; EN 60079-1; EN 60079-7; EN 60079-11; EN 60079-15; EN 60079-31**
- Certificato EAC  
**TC RU C-IT.AA87.B.00992**
- Certificato IECEx  
**IECEx IMQ 17.0013;**
- Certificato ATEX  
**IMQ 17 ATEX 020; IMQ 17 ATEX 023 (Ex nR);**
- Grado di protezione secondo CEI EN 60529 IEC 60529  
**IP66/IP68 (3gg a 50mt)**

- Standard IECEx  
**IEC 60079-0; IEC 60079-1; IEC 60079-7; IEC 60079-11; IEC 60079-15; IEC 60079-31**
- Standard ATEX  
**EN 60079-0; EN 60079-1; EN 60079-7; EN 60079-11; EN 60079-15; EN 60079-31**
- Certificate EAC  
**TC RU C-IT.AA87.B.00992**
- Certificate IECEx  
**IECEx IMQ 17.0013;**
- Certificate ATEX  
**IMQ 17 ATEX 020; IMQ 17 ATEX 023 (Ex nR);**
- Protection degree  
CEI EN 60529 IEC 60529  
**IP66/IP68 (3days at 50mt)**



Silicone

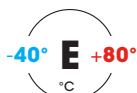

EPDM

## ■ Pressacavo doppia tenuta 6018ADS Double seal cable gland 6018ADS

### Cavo armato Armoured cable

Guarnizione O-Ring maggiorata (per una maggiore tenuta in qualsiasi connessione)  
Larger O-Ring seal (for a greater hold in any connection)

Sede O-Ring  
(garanzia di tenuta alla sovrappressione)  
O-Ring seat (guarantee of hold at overpressure)

Guarnizione tenuta interna marcata  
(rif.  $\varnothing$  cavo/corpo)  
Seal with internal hold marked (ref.  $\varnothing$  cable/body)

Corpo intermedio  
Intermediate body

Guarnizione di tenuta esterna marcata  
(rif.  $\varnothing$  cavo/corpo)  
Seal with external hold marked (ref.  $\varnothing$  cable/body)

Cono premiarmatura  
(disponibile anche in versione ridotta)  
Armour clamping cone  
(also available in reduced version)

Anello premiarmatura  
Compression seal ring

Anello di frizione  
Friction ring

Dado di serraggio  
Lock nut

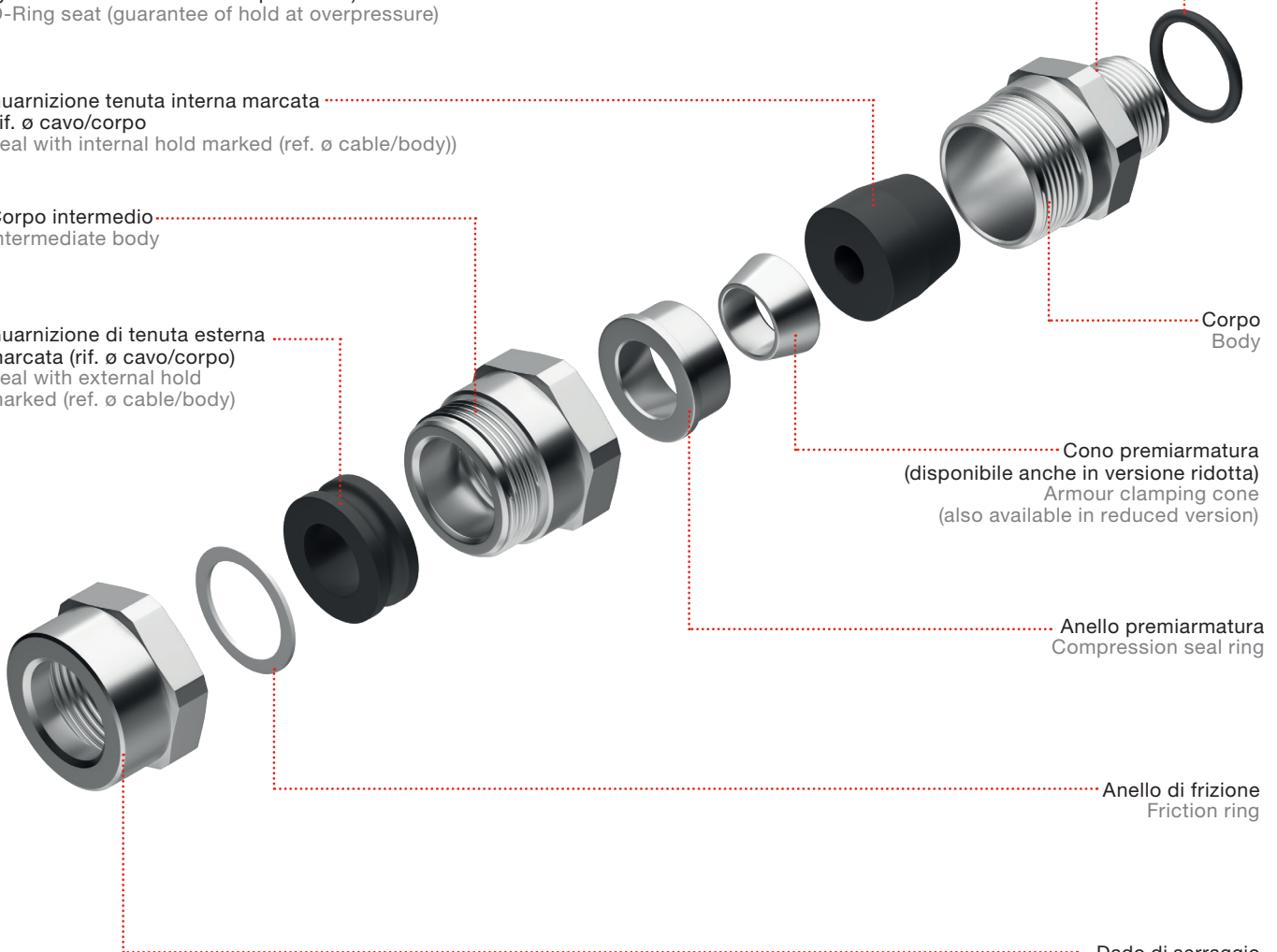

## ■ Pressacavo doppia tenuta 6018ADS Double seal cable gland 6018ADS

### Cavo armato Armoured cable

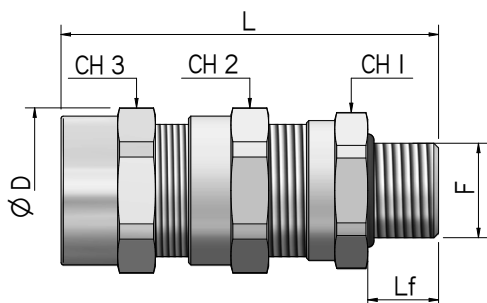

CODICE KIT CODE KIT	ESTERNO CAVO OUTER CABLE	SERRAGGIO CAVO CABLE TIGHTENING	FILETTO THREAD	LUNGHEZZA FILETTO THREAD LENGTH	DIMENSIONE CHIAVE mm		DIAMETRO ESTERNO EXTERNAL DIAMETER	LUNGHEZZA TOT. TOTAL LENGTH
	ømin- ømax	ømin- ømax	F	Lf mm	CH1	CH2 / CH3	øD mm	L tot
6018ADSAKGM1EB	6 - 15	5 - 10	M16x1.5	15,0	24,0	26,0	28,0	78,5
6018ADSAKGM2EB	6 - 15	5 - 10	M20x1.5	15,0	24,0	26,0	28,0	78,5
6018ADSBKGM2EB	10 - 19	5.5 - 13	M20x1.5	15,0	30,0	32,0	35,0	80,0
6018ADSBKGM3EB	10 - 19	5.5 - 13	M25x1.5	15,0	30,0	32,0	35,0	80,0
6018ADSCKGM3EB	15 - 24	10.5 - 18	M25x1.5	15,0	35,0	36,0	39,0	80,0
6018ADSDKGM4EB	20 - 31	15 - 24	M32x1.5	15,0	42,0	45,0	49,0	97,0
6018ADSEKGM5EB	26 - 37	21 - 30	M40x1.5	15,0	48,0	50,0	55,0	98,0
6018ADSFKGM6EB	31 - 43	24 - 36	M50x1.5	15,0	55,0	58,0	63,0	98,0
6018ADSGKGM7EB	42 - 53	36 - 45	M63x1.5	15,0	68,0	68,0	74,0	98,0
6018ADSHKGM8EB	52 - 64	45 - 54	M75x1.5	15,0	80,0	80,0	88,0	98,0
6018ADSIKGM9EB	64 - 72	54 - 62	M90x2	20,0	100,0	102,0	109,0	123,0
6018ADSLKGM9EB	70 - 78	62 - 68	M90x2	20,0	100,0	102,0	109,0	123,0

# ■ Pressacavo doppia tenuta 6018ADS

## Double seal cable gland 6018ADS

### Guida alla composizione del codice

#### Code composition guide

Per la composizione del codice Kit Pressacavo **6018ADS** occorre selezionare l'**ARTICOLO** desiderato, conoscere il **DIAMETRO SERRAGGIO CAVO** o **CAVO ESTERNO** quindi scegliere la taglia **SIZE** corrispondente. Individuare la **TIPOLOGIA FILETTATURA** (un solo valore in base all'impiego del pressacavo). Infine scegliere il **POLIMERO GUARNIZIONI** e il **MATERIALE**.

For the composition of Cable Gland **6018ADS** Kit code, select the required **TYPE**, find out the **CABLE TIGHTENING** or **OUTER CABLE DIAMETER** and then select the corresponding **SIZE**. Identify the **THREAD TYPE** (one value only based on cable gland use). Then select the **GASKET POLYMER** and the **MATERIAL**.

#### POLIMERO GUARNIZIONI GASKET POLYMER TYPE

<b>E</b>	EPDM
<b>S</b>	Silicone

#### MATERIALE MATERIAL TYPE

<b>B</b>	Ottone nichelato Nickel plated brass
<b>X</b>	AISI 316L Acciaio Inox AISI 316L stainless steel
no letter	Ottone Brass

VERSIONE VERSION	SIZE SIZE	KIT	TIPO FILETTO THREAD TYPE	POLIMERO POLYMER	MATERIALE MATERIAL
<b>6018ADS</b>	.....	<b>KG</b>	.....	.....	.....

**INDICARE SOLO UNA TIPOLOGIA DI FILETTATURA**  
INDICATE ONLY ONE TYPE OF THREADING

SIZE	SERRAGGIO CAVO CABLE TIGHTENING Ø min-max	CAVO ESTERNO OUTER CABLE Ø min-max	ISO 262		NPT		ISO 7/1		PG	ISO228		
<b>A</b>	5-10	6-15	<b>M1</b>	M16x1.5	<b>N1</b>	3/8"	<b>I1</b>	3/8"	<b>P1</b>	9	<b>G1</b>	3/8"
<b>A</b>	5-10	6-15	<b>M2</b>	M20x1.5	<b>N2</b>	1/2"	<b>I2</b>	1/2"	<b>P2</b>	11	<b>G2</b>	1/2"
<b>B</b>	5.5-13	10-19	<b>M2</b>	M20x1.5	<b>N2</b>	1/2"	<b>I2</b>	1/2"	<b>P2</b>	11	<b>G2</b>	1/2"
<b>B</b>	5.5-13	10-19	<b>M3</b>	M25x1.5	<b>N3</b>	3/4"	<b>I3</b>	3/4"	<b>P3</b>	13,5	<b>G3</b>	3/4"
<b>C</b>	10.5-18	15-24	<b>M3</b>	M25x1.5	<b>N3</b>	3/4"	<b>I3</b>	3/4"	<b>P3</b>	13,5	<b>G3</b>	3/4"
<b>D</b>	15-24	20-31	<b>M4</b>	M32x1.5	<b>N4</b>	1"	<b>I4</b>	1"	<b>P4</b>	16	<b>G4</b>	1"
<b>E</b>	21-30	26-37	<b>M5</b>	M40x1.5	<b>N5</b>	1"1/4	<b>I5</b>	1"1/4	<b>P5</b>	21	<b>G5</b>	1"1/4
<b>F</b>	24-36	31-43	<b>M6</b>	M50x1.5	<b>N6</b>	1"1/2	<b>I6</b>	1"1/2	<b>P6</b>	29	<b>G6</b>	1"1/2
<b>G</b>	36-45	42-53	<b>M7</b>	M63x1.5	<b>N7</b>	2"	<b>I7</b>	2"	<b>P7</b>	36	<b>G7</b>	2"
<b>H</b>	45-54	52-64	<b>M8</b>	M75x1.5	<b>N8</b>	2"1/2	<b>I8</b>	2"1/2	<b>P8</b>	42	<b>G8</b>	2"1/2
<b>I</b>	54-62	64-72	<b>M9</b>	M90x2	<b>N9</b>	3"	<b>I9</b>	3"	<b>P9</b>	48	<b>G9</b>	3"
<b>L</b>	62-68	70-78	<b>M9</b>	M90x2	<b>N9</b>	3"	<b>I9</b>	3"	<b>P9</b>	48	<b>G9</b>	3"

#### Esempio Example

### 6018ADSAKGN1EB

Pressacavo versione 6018ADS, dimensione A, formato Kit, filettatura NPT 3/8", polimero EPDM e Ottone nichelato.  
6018ADS cable gland version, dimension size A, Kit format, NPT 3/8" thread, EPDM e nickel-plated brass.